

Flat

VIBIA

5970

Design By Ichiro Iwasaki

The Flat table lamp offers multiple functionality; material and light are integrated in a single body. The Flat collection contains various planes of light that rise up to become self-illuminating supports.

Model Sheet

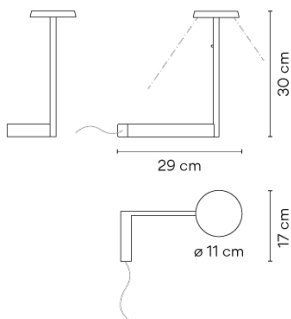

Finish	 37 Terra Red NCS S 4040-Y70R
	 11 Black NCS S 8500N
	 47 Green L1 NCS S 4005-G80Y

LED temperature color 2700 K

Dimming Push

Installation type Surface Canopy

Materials
Body: Steel
Base: Steel
Head: Aluminium
Reflector: Aluminum

Light source 1 x LED PLATE 7W 400mA
F

LED CRI>90 1200 lm 171.4
2700 K

Driver CC - Constant Current 400
100-240 V 50/60 HZ

Remarks 24V transformer at plug

F Dimmer LED
 IP20 Bi-volt 50-60Hz PUSH

Application Table Lamps

Packaging
1 Box
0.425 m x 0.365 m x 0.247 m
Gross weight 2.1
Net weight 1.11
Vol. 0.0383

Lighting effect

General Lighting

Lamp for general lighting that equally distributes the light in all directions.



Photometric Data

Efficiency 67.88 lm/W
Coordinate System CG
Total Flux 598.17 lm
Maximum Value 239.87 cd

Other Applications

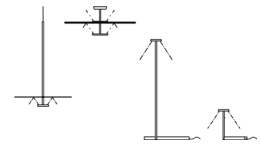

All of our products come with a five-year warranty.
Check our legal terms at www.vibia.com/warranty

Vibia Lighting, S.L.U.

Office / Oficina
Progrés 4-6, 08850 Gavà, Barcelona, Spain.

International T +34 934 796 971
Spain / Portugal T +34 934 796 970

customer.service@vibia.com
vibia.com